



# **3D CAMERA iHawkP008G**

### 3D CAMERA SETUP

It is recommended to secure the product using the screw holes on the back side, where two 2mm diameter through holes serve as positioning points, and four M3 threaded holes are used for screw fastening (suggested screw insertion depth  $\leq 3\text{mm}$ , positioning post sinking depth  $\leq 2\text{mm}$ ), as shown in the figure below. If the customer adopts alternative fastening methods, the module must be installed into the customer's equipment without causing deformation or compression of the module, to avoid affecting its precision due to squeezing or distortion.

推荐以模组背面螺丝孔进行固定，其中两个直径 2mm 过孔用作定位，四个 M3 螺纹孔用作螺丝固定，（建议螺丝拧入深度 $\leq 3\text{mm}$ ，定位柱沉入深度 $\leq 2\text{mm}$ ），如下图。若客户采用其他固定方式，则要求模组安装到客户设备中，不允许安装导致模组有变形、挤压的情况，避免模组受挤压、变形，影响精度。

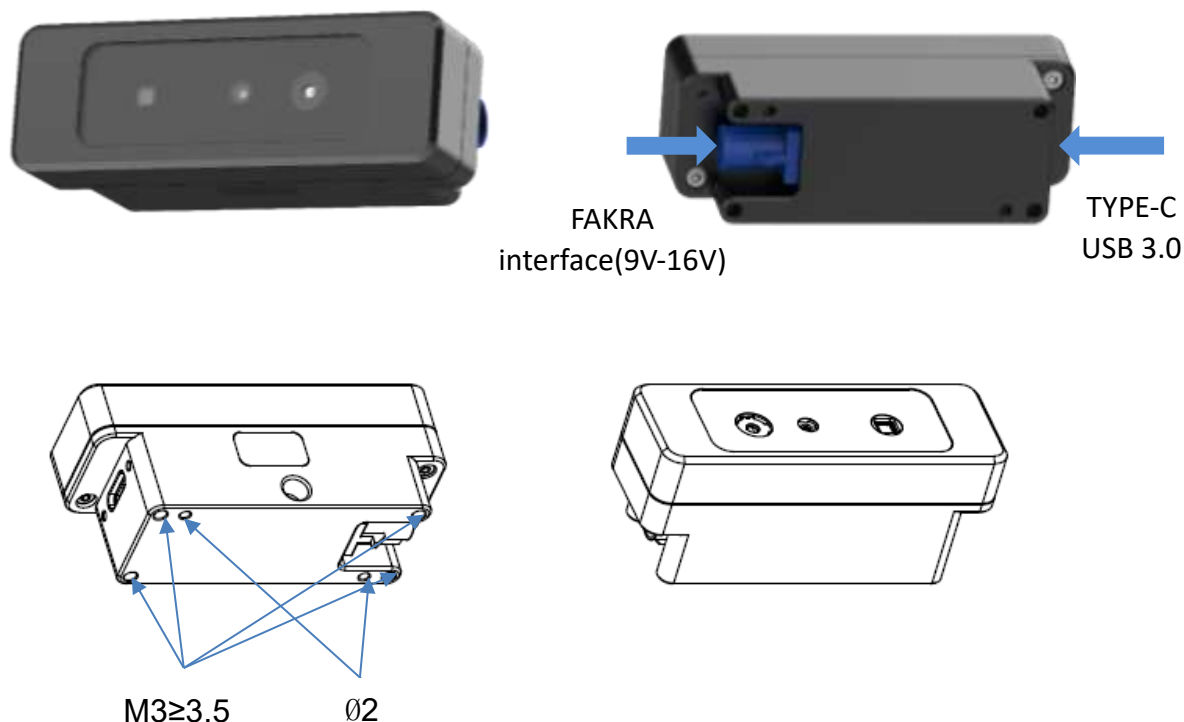

## REGULATORY AND SAFETY INFORMATION

This product is classified as Class 1 Laser Product under the EN/IEC 60825-1 Edition 3(2014) internationally.



CAUTION: Use of controls or adjustments or performance of procedures other than those specified herein may result in hazardous radiation exposure.

### Safety and Handling Instructions:

- Do not power on the product if any external damage was observed.
- Do not attempt to open any portion of this laser product. There are no user serviceable parts.
- Invisible laser radiation when opened, Avoid direct exposure to beam.
- Do not modify or service the product in any way. Modification or service of the hardware might cause the emissions to exceed the Class 1 level.
- Do not try to update camera firmware that is not officially released for specific camera module and revision.

此产品在 EN/IEC60825-1 国际版本 3(2014 年)下被归为 1 类激光产品。



小心:使用未在本文指定的控制、调节或执行步骤可能会导致有害的辐射曝露。

### 安全和处理注意事项:

- 如果观察到任何外部损坏、不要打开产品电源。
- 不要试图打开此激光产品的任何部分。该处没有用户可维护的部件。
- 打开时会有不可见的激光辐射。避免直接暴露在光束之下。
- 不要以任何方式修改或维修此产品。硬件的修改或维修可能会导致排放超过 1 级。
- 不要试图更新为并非针对特定摄像头模块和版本的非官方版本。

**Manufacture:**

Shenzhen Berxel Photonics Co., Ltd.

[www.berxel.com](http://www.berxel.com)



Europe

This product complies with the applicable European directives.

CAUTION: To keep the product in compliance with the European CE requirement, the device must be installed with CE certified computer equipment which meets the Class B limits. Operation with non-certified computers or incorrect cables may result in interference to other devices or undesired effect to the product.



“In the EU, this symbol means that this product must not be disposed of with household waste. It is your responsibility to bring it to a designated collection point for the recycling of waste electrical and electronic equipment. For more information, please contact your local collection center or your point of purchase of this product.”

